

# REHAU SLINOVA SLIDING DOOR SYSTEM

## Main Profiles

Note: The below foiled part numbers will precede a 3 digit colour variant number

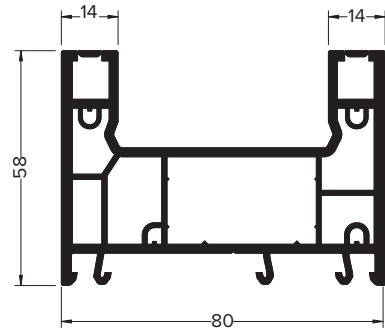

575602  
595802 (Foiled)  
Reinforcement 35 x 20  
**DOOR FRAME**

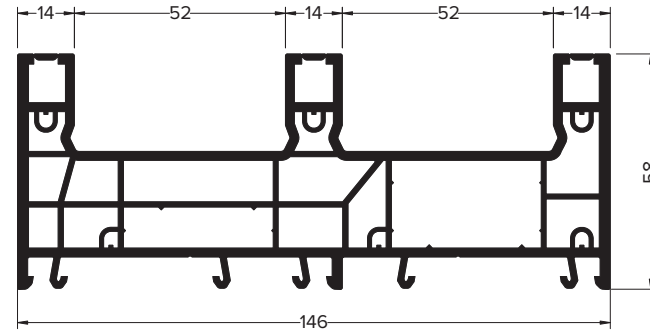

575603  
595803 (Foiled)  
Reinforcement 35 x 20 & Reinforcement 35 x 8  
**TRIPLE TRACK FRAME**

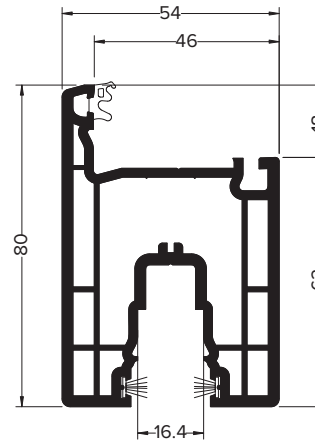

575305  
595405 (Foiled)  
Reinforcement 34.5 x 40.8  
**DOOR SASH**

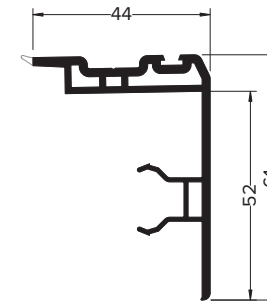

575506  
595606 (Foiled)  
**INTERLOCK**

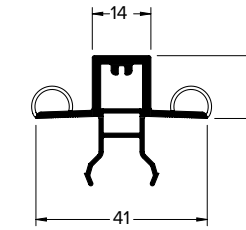

575507  
**3/4 PANE SEAL**

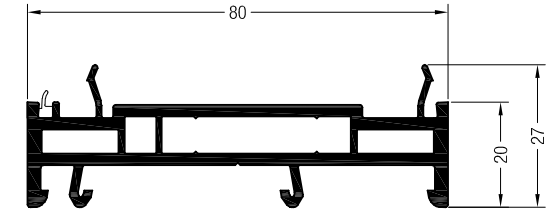

538025  
568025 (Foiled)  
Reinforcement 35 x 6  
**20MM FRAME EXTENSION**

## Finishing Profiles

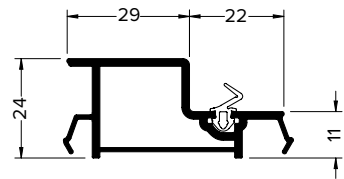

575626  
595726 (Foiled)  
**COVER PROFILE**

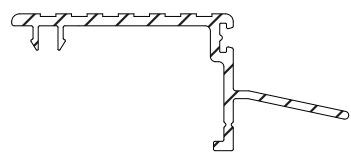

368136  
**STANDARD TREAD PLATE**

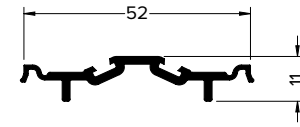

575622  
**THERMAL PROFILE WITH DRAINAGE**

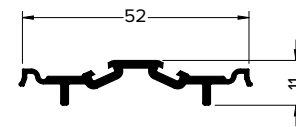

575722  
**THERMAL PROFILE NO DRAINAGE**

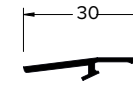

362276  
**FINISHING TRIM**

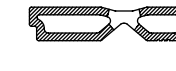

372962  
**SILL ADAPTOR**

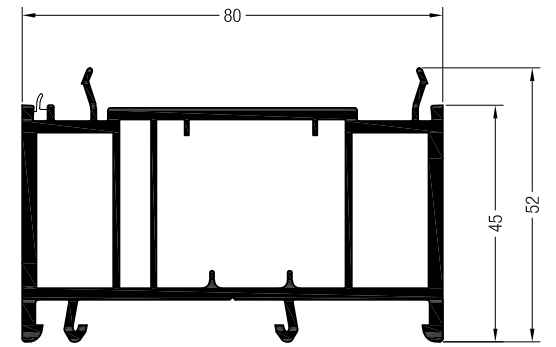

538045  
568045 (Foiled)  
Reinforcement 23 x 28  
**45MM FRAME EXTENSION**

## Glazing

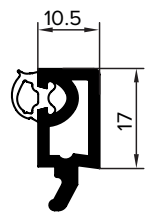

559605  
589605 (Foiled)  
**28MM BEAD**

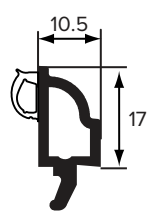

559600  
589600 (Foiled)  
**28MM SCULPTURED BEAD**

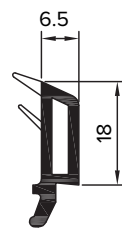

560580  
594330 (Foiled)  
**32MM BEAD**

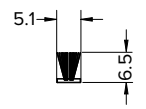

334728  
**5.1 x 6.5mm BRUSHPILE**  
for interlock & treadplate

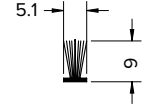

357855  
**5.1 x 9mm BRUSHPILE**  
for thermal profile

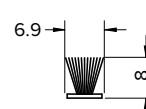

371038  
**6.9 x 8mm BRUSHPILE**  
for cover profile

## Reinforcement

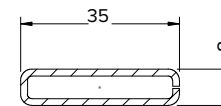

357835  
**REINFORCEMENT**  
35 X 8 X 1.5MM

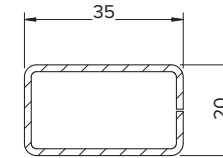

357836  
**REINFORCEMENT**  
35 X 20 X 1.5MM

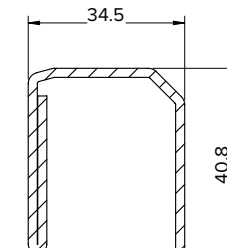

357832  
**REINFORCEMENT**  
34.1 X 40.8 X 2MM

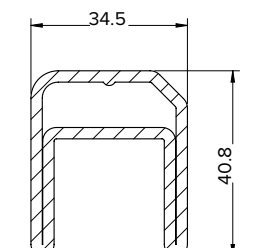

357833  
**REINFORCEMENT**  
34.1 X 40.8 X 2.5MM

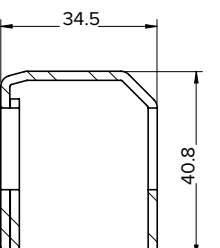

361488  
**REINFORCEMENT**  
34.1 X 40.8 X 2MM

## Ancillaries

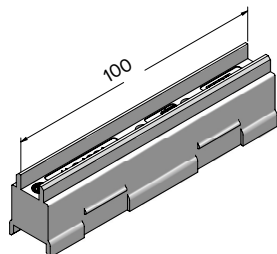

357849  
**SASH SPACER**

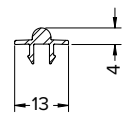

357837  
**RUNNING TRACK**

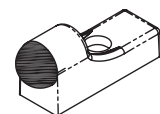

318023  
**DOOR BUMP STOP**  
for use on triple track doors only

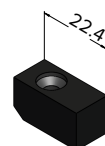

362274  
**CORNER BUNG**

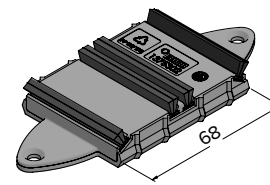

375302  
**ANTI-LIFT BLOCK**

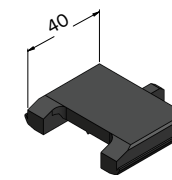

362525  
**ANTI-LIFT BLOCK EXTENSION**

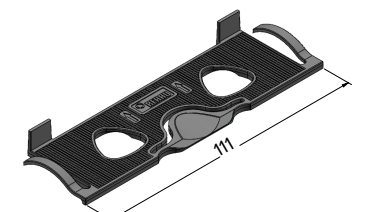

375310  
**GLAZING PACKER**